

**NOTES**

1. CONCRETE STRENGTH TO BE 50 MPa
2. ALL DIMENSIONS IN MILLIMETRES U.N.O.
3. DRWGS ARE NOT TO SCALE
4. REINFORCEMENT IN ACCORDANCE WITH AS4671 AND AUS PITS COMPUTATIONS
5. STEP IRONS JFH255 OR EQUIVALENT ARE TO BE INSTALLED TO PROJECT REQUIREMENTS
6. FOR PIT SIZES AVAILABLE, PLEASE REFER TO TABLE OF PIT SIZES IN THE AUS PITS CATALOGUE
7. WHERE A SUBSOIL DRAIN IS DISCHARGED INTO A PIT, THE OUTLET OF THE SUBSOIL DRAIN SHALL BE LOCATED ABOVE THE OBVERT OF THE PIPES / CULVERTS UNLESS OTHERWISE APPROVED.
8. GRATES & FRAMES TO BE HOT DIPPED GALVANISED & COMPLY WITH AS3996. GRATES TO BE HINGED & HAVE A POSITIVE MECHANICAL RETAINER TO SECUTE THEM IN PLACE WHEN IN THE OPEN POSITION.

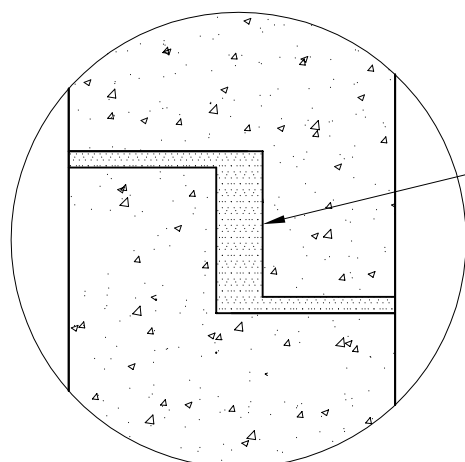

**DETAIL 'A'**

JOINT TO BE FILLED WITH A NON-SHRINK GROUT OR MASTIC TYPE PRODUCT DURING CONSTRUCTION TO PROJECT AND AUTHORITY SPECIFICATIONS

FOR PROFILE OF PIT TOP & COVER TYPE REFER TO PIT SCHEDULE, RELEVANT AUS PITS DWG. & AUTHORITY STD. DWG.

GROUND LEVEL

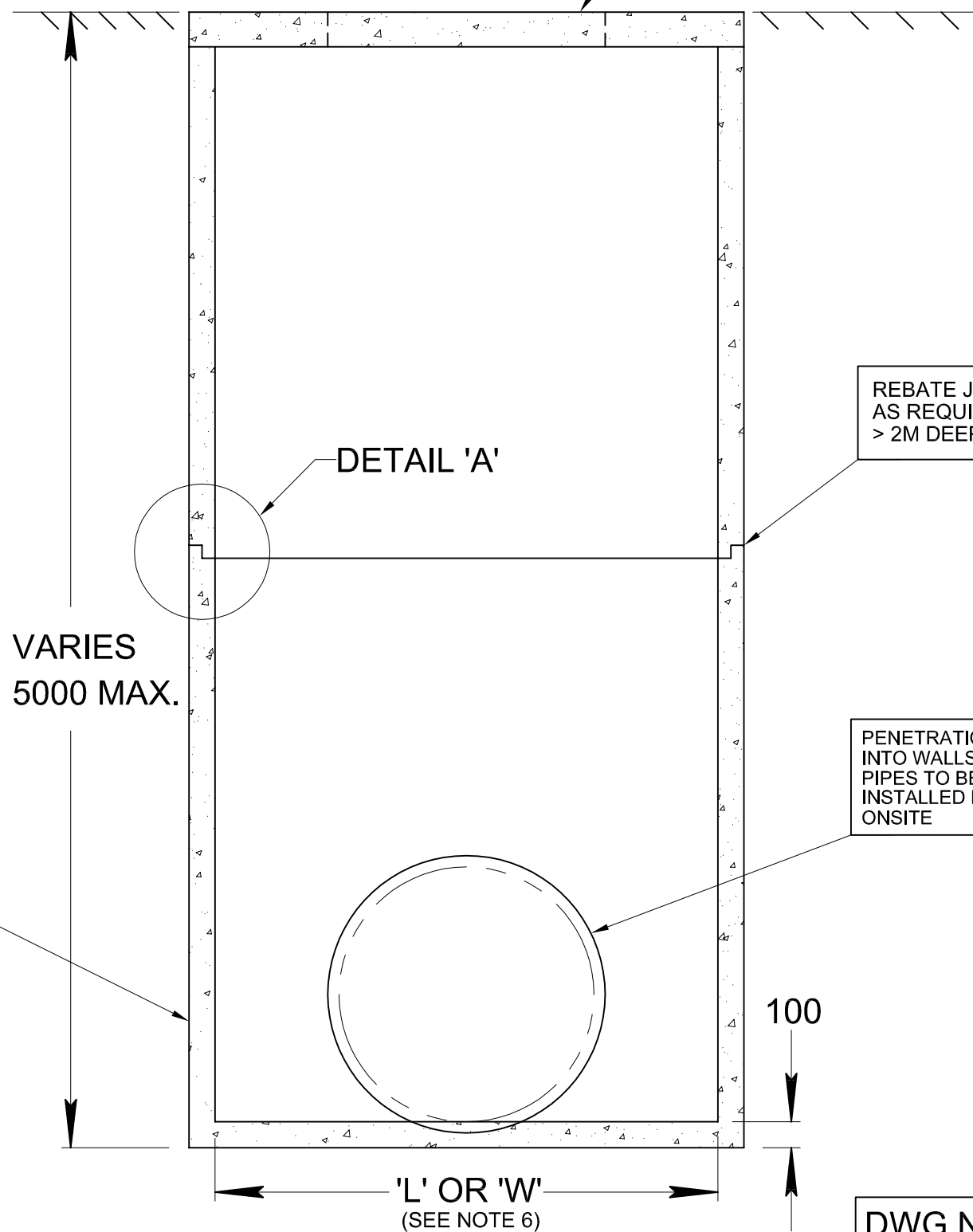

REBATE JOINTS PROVIDED AS REQUIRED FOR PITS > 2M DEEP

PENETRATIONS CUSTOM CAST INTO WALLS AS REQUIRED. PIPES TO BE SUPPLIED & INSTALLED BY OTHERS ONSITE

VARIES 5000 MAX.

100

'L' OR 'W'  
(SEE NOTE 6)

DWG. NOT TO SCALE

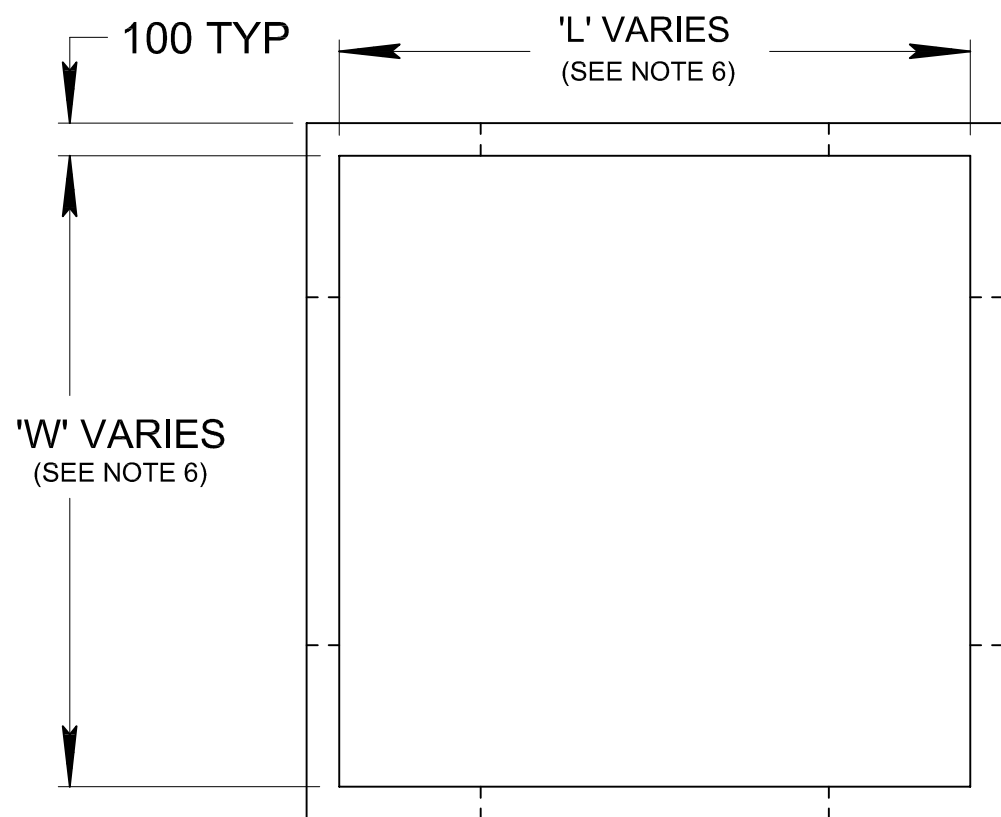

**TYPICAL PLAN VIEW**

**TYPICAL SECTION VIEW**

PRE-CAST CONCRETE PIT WITH 100mm THICK WALLS & BASE

REVISION	DATE	INITIALS	DETAILS
	NOV 09		INITIAL DESIGN

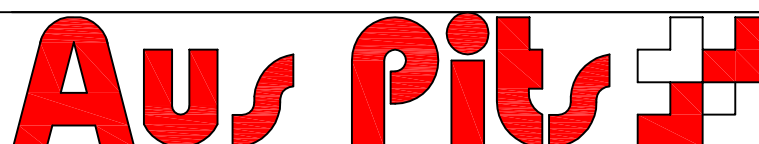

STANDARD DRAWING			
UNHAUNCHED PIT TO SUIT QDMR			
TYPICAL DETAILS			
DRAWN BY: G.J.F.	APPROVED BY: P. MOULTON	DRG NO: AP-SD-SW-003	REV: 0